



Outer front template.

Glue left template to left and right template to right

Left Front

Right Front



Outer left template.

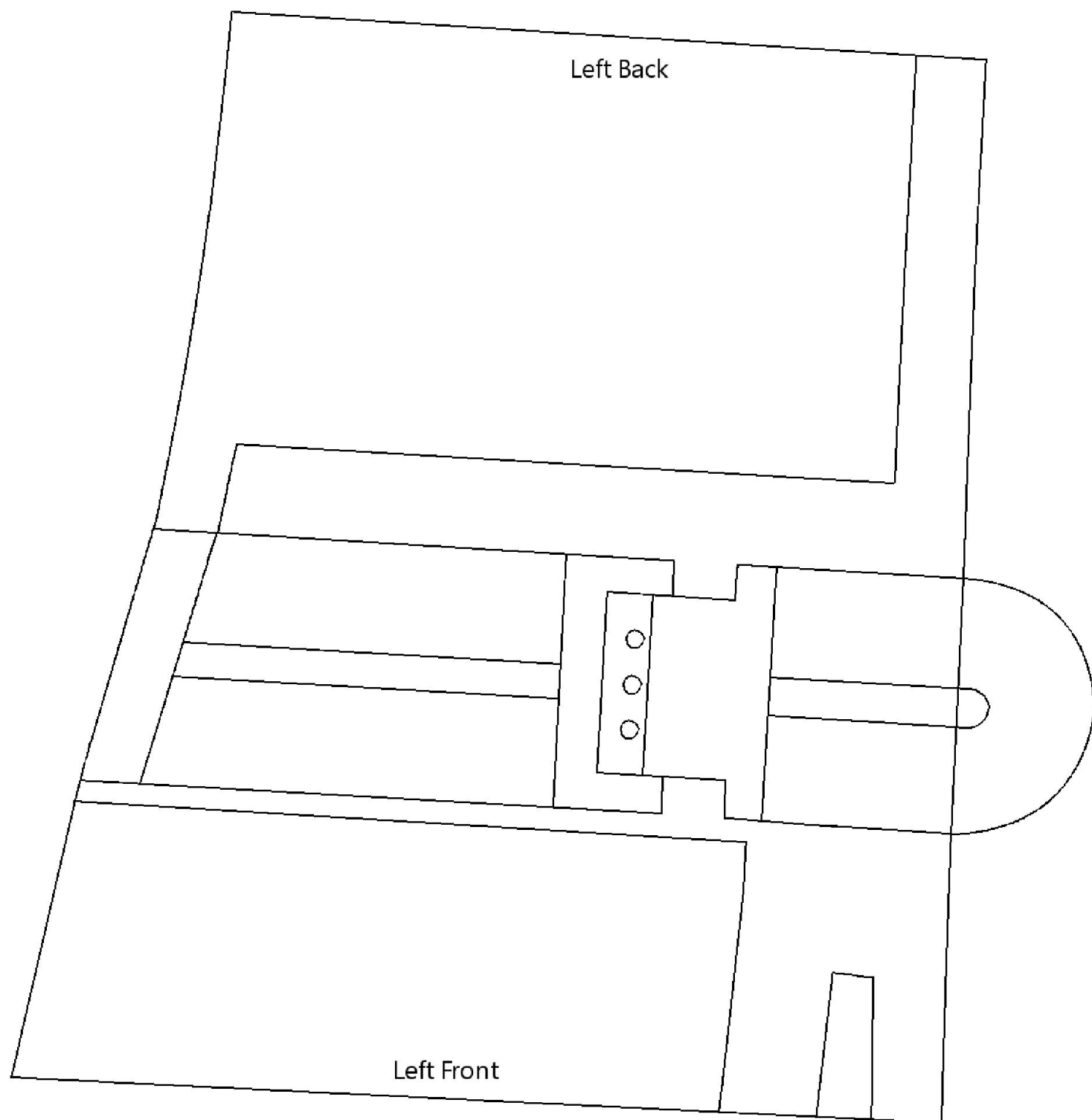



Outer right template.

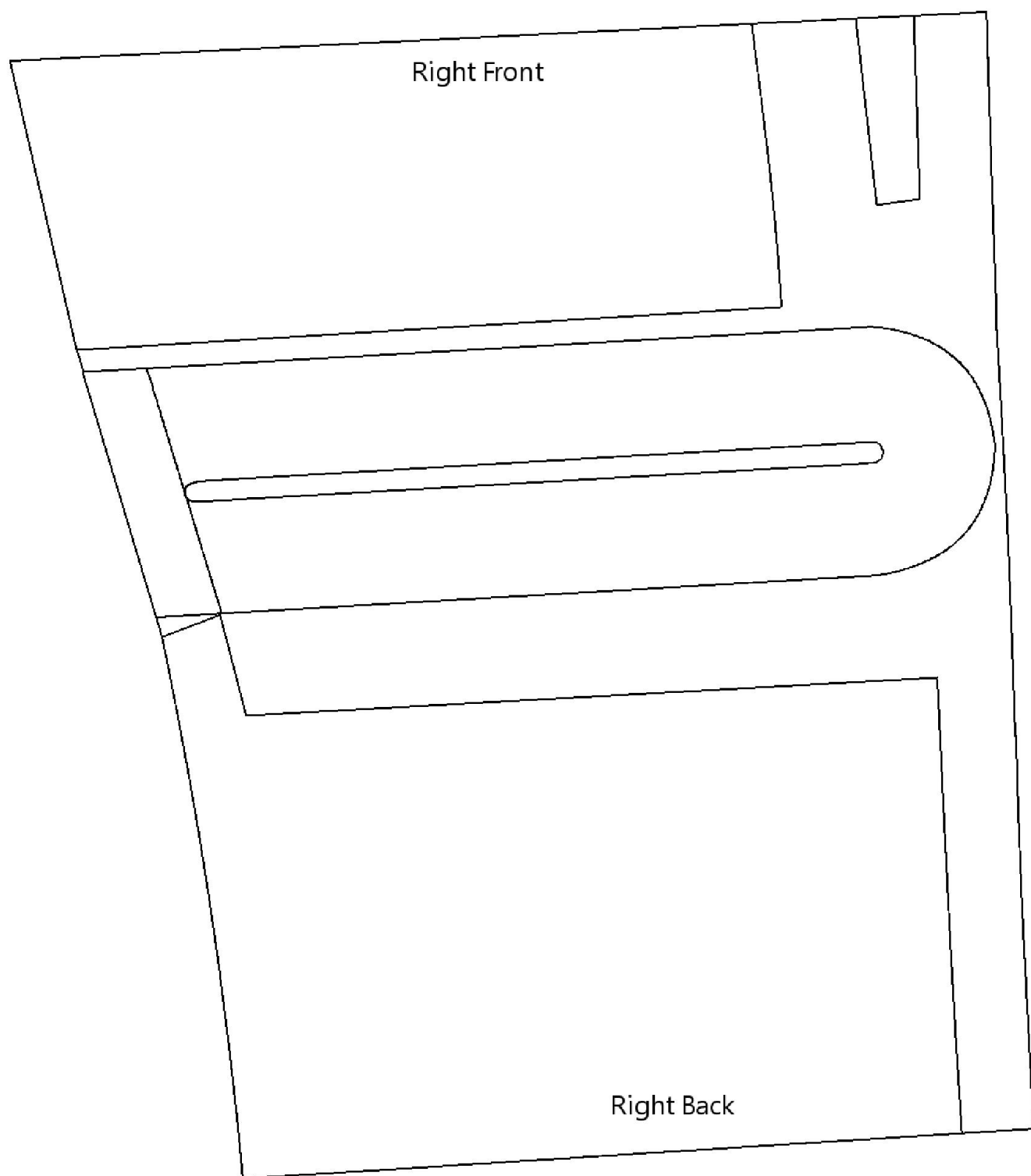



Outer right template.

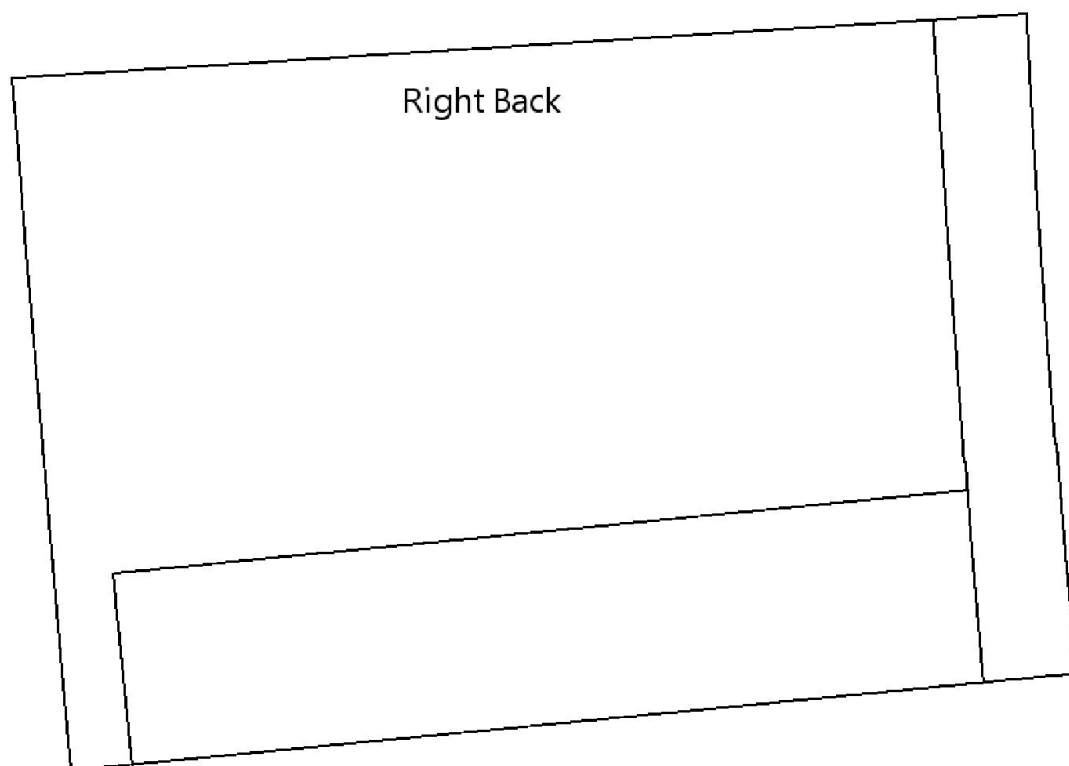

Outer left template.

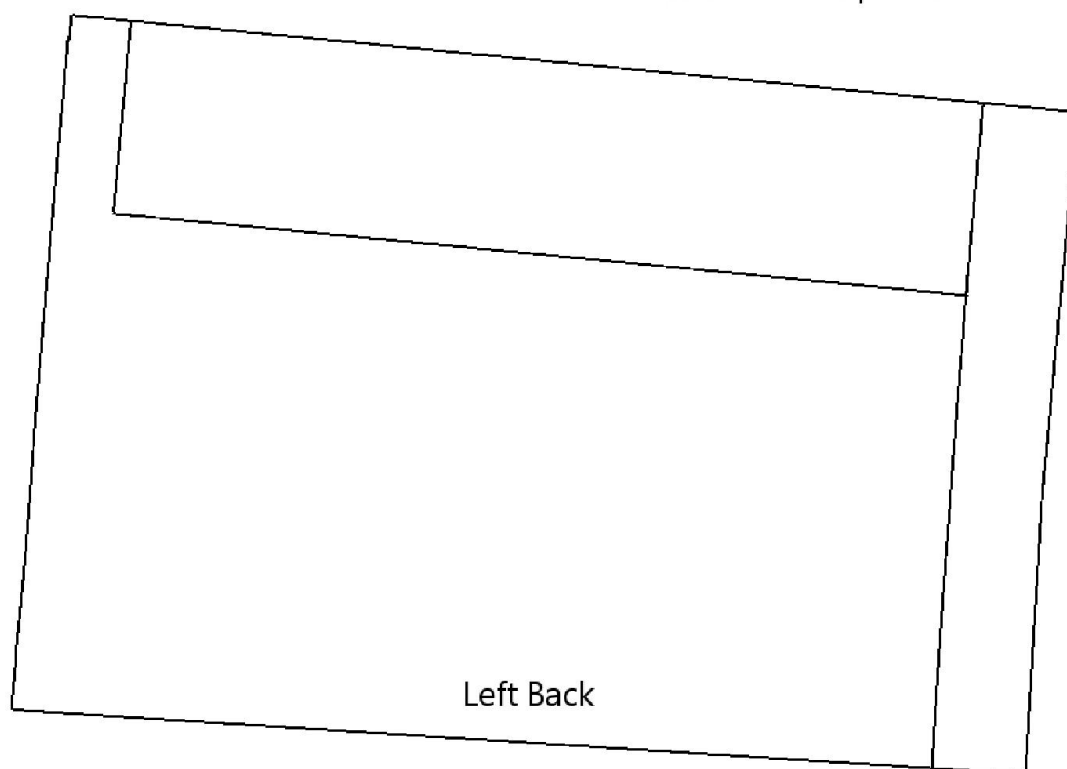



Inner front template.

Glue left template to left and right template to right

Left Front

A large, irregular polygon representing the left front template. It has a short top edge, a long right edge, a long bottom edge, and a left edge that is mostly vertical with a slight inward curve at the top and bottom. A horizontal line divides the shape into two roughly equal halves.

Right Front

A large, irregular polygon representing the right front template. It is a mirror image of the left front template. It has a short top edge, a long left edge, a long bottom edge, and a right edge that is mostly vertical with a slight inward curve at the top and bottom. A horizontal line divides the shape into two roughly equal halves.



Inner left template.

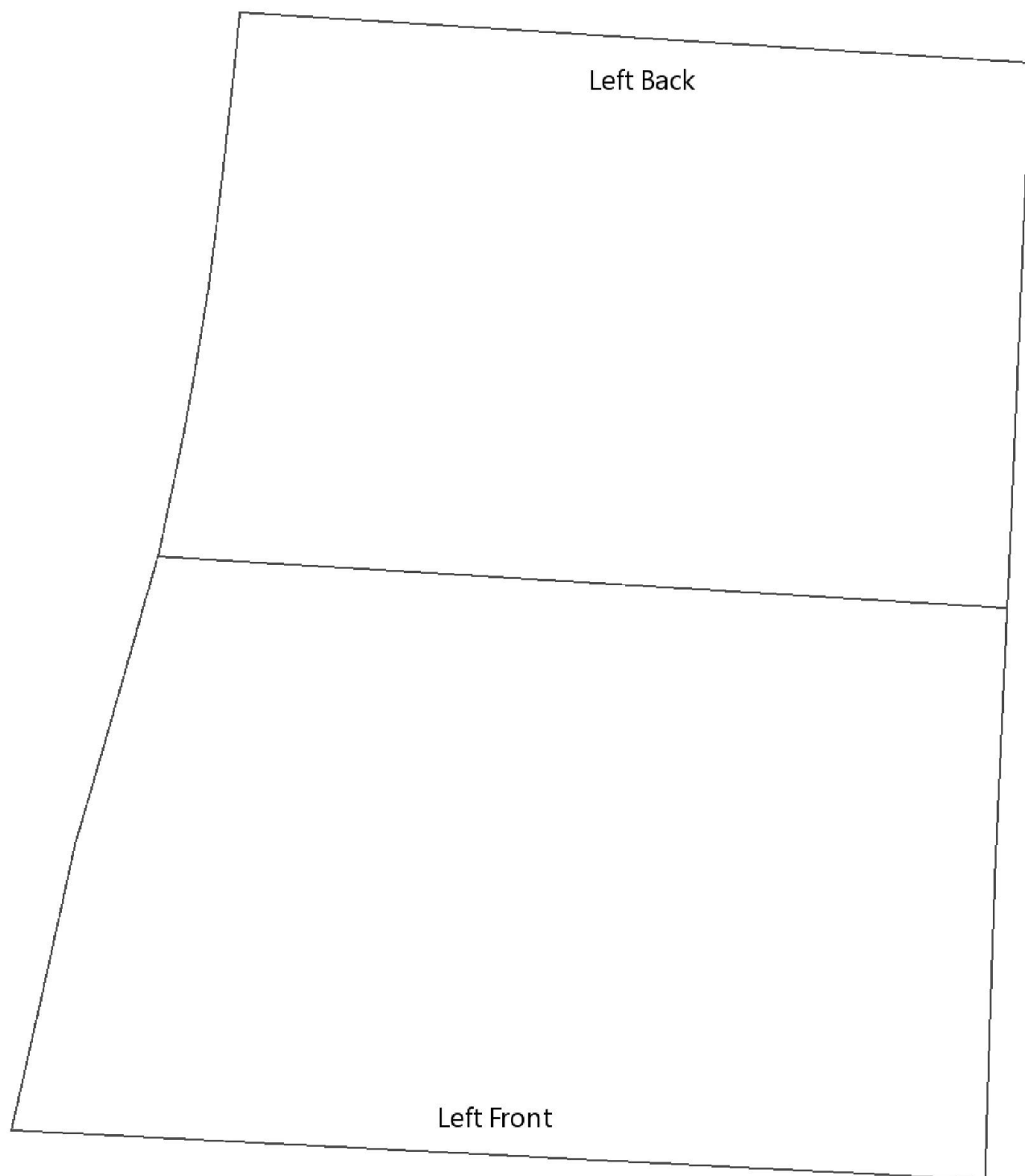



Inner right template.

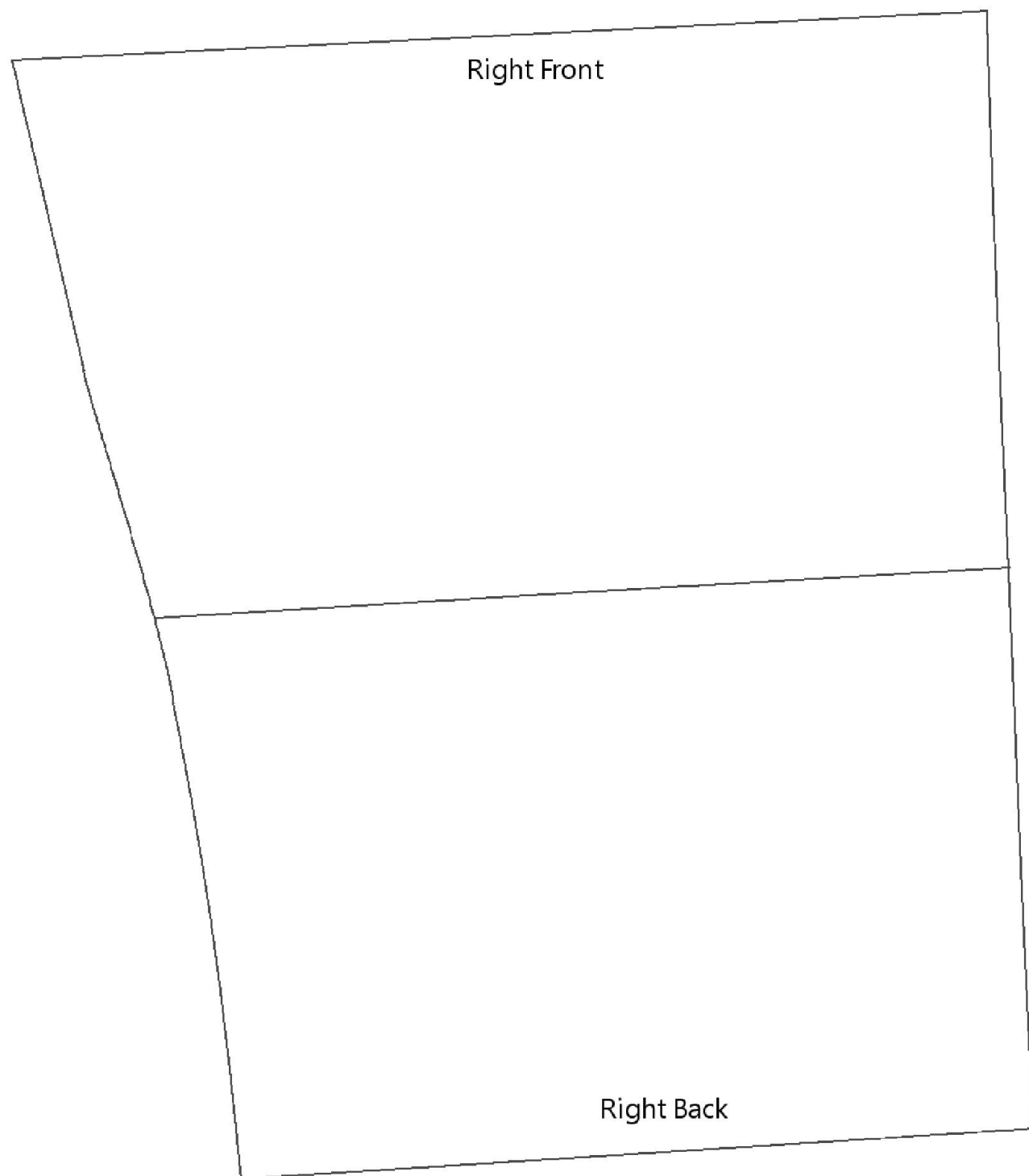



Inner right template.

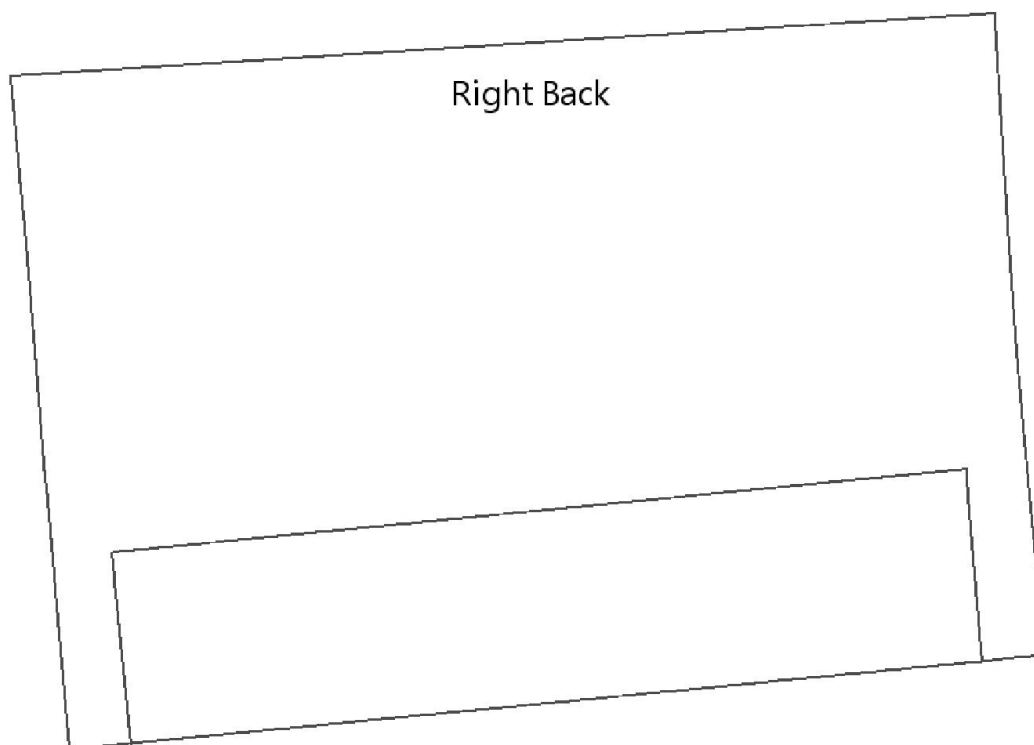

Inner left template.

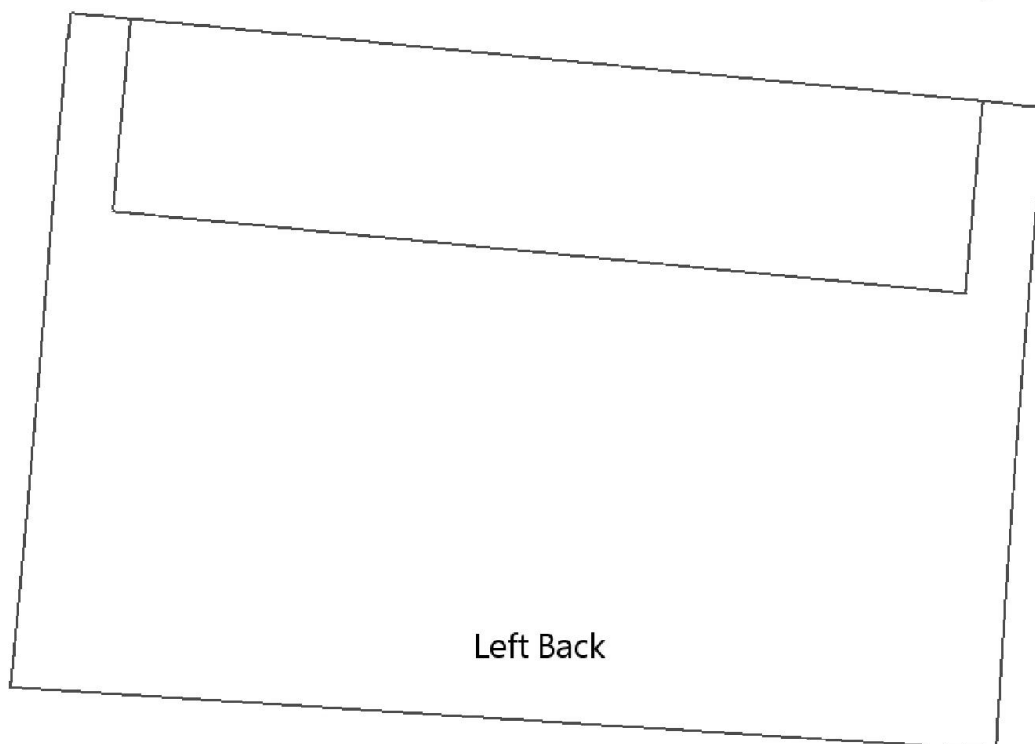

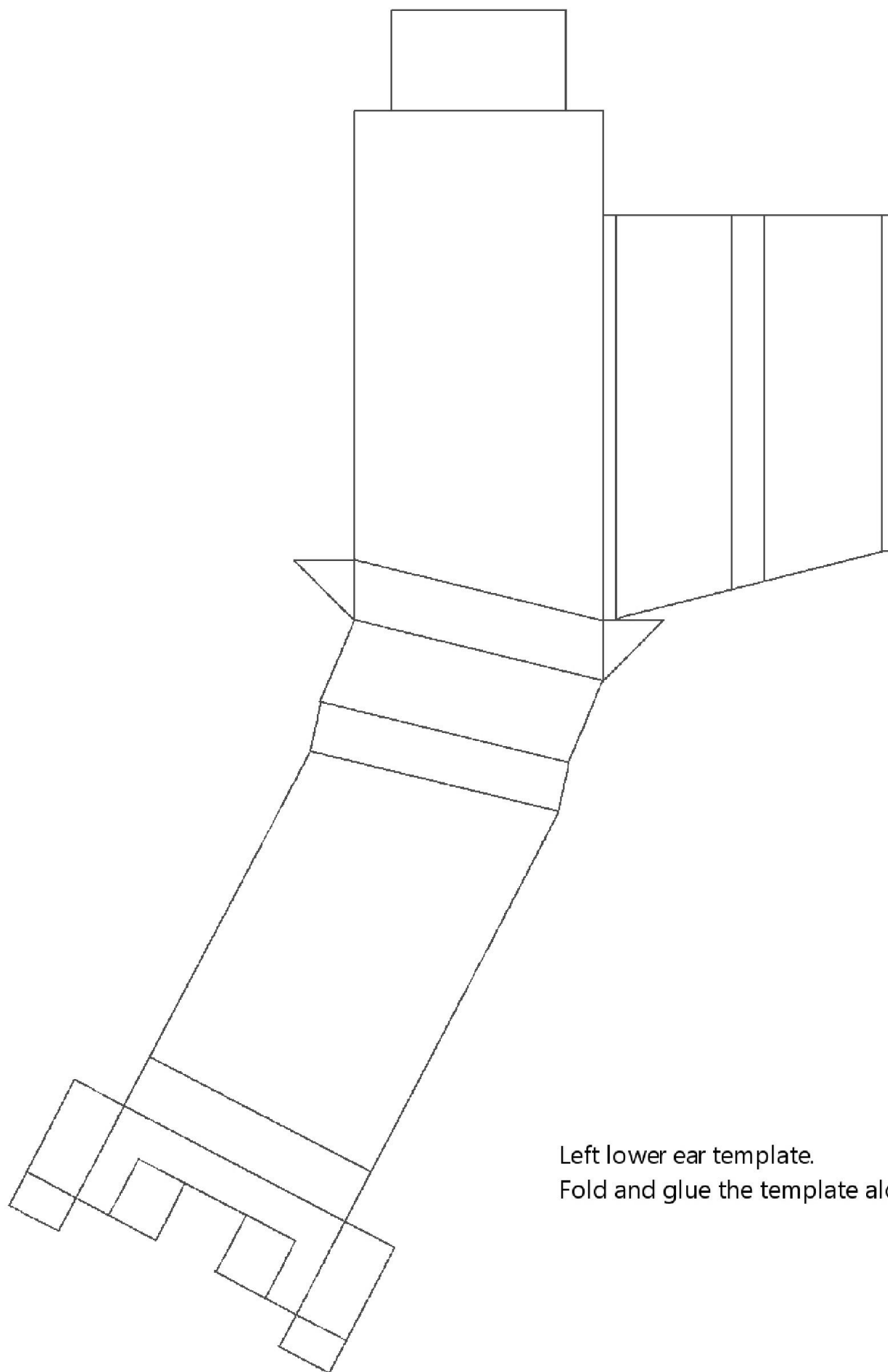

Left lower ear template.

Fold and glue the template along the lines



Left upper ear templates

Fold and glue the template along the lines

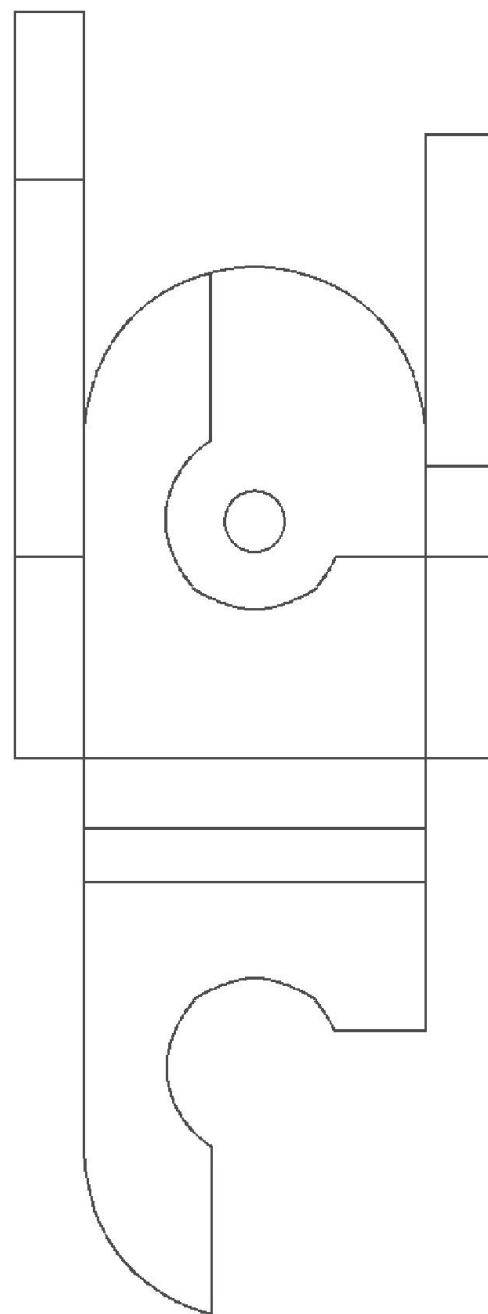
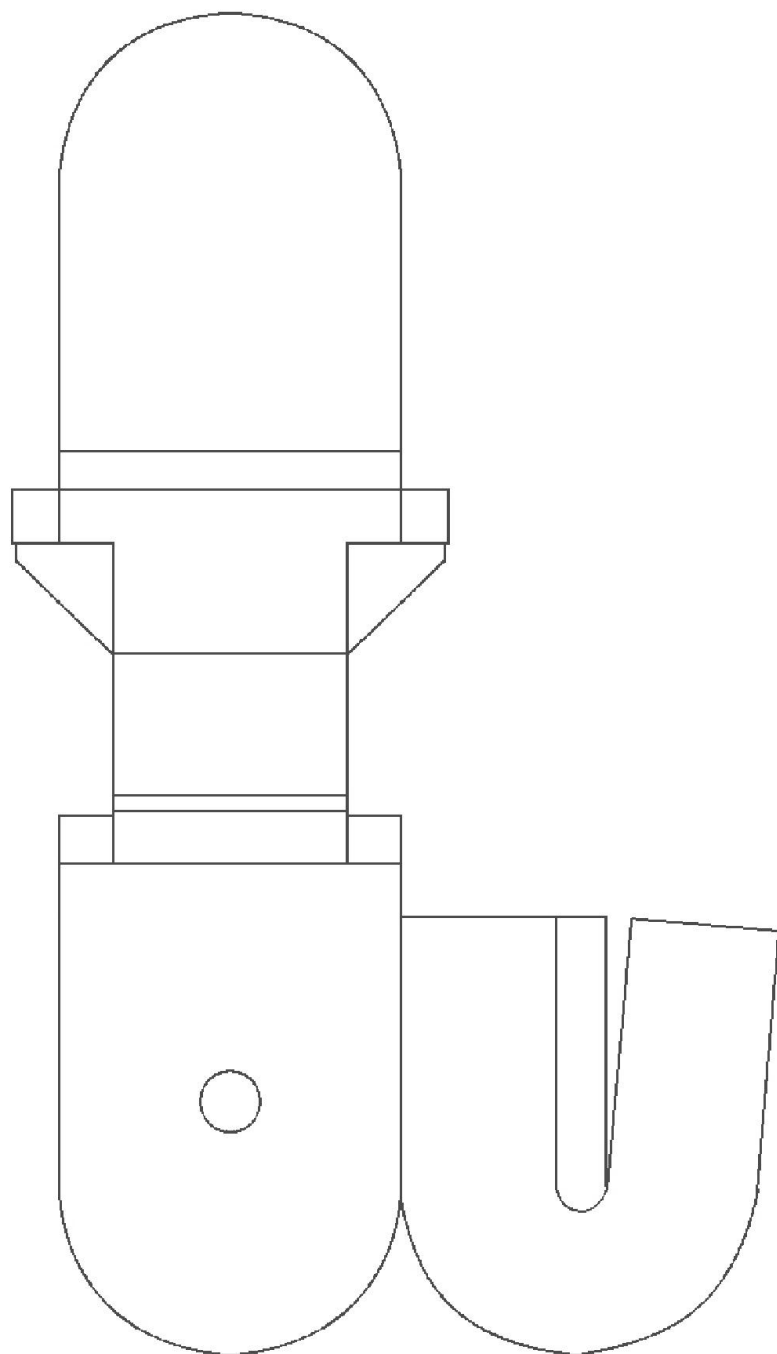

Front arrows position

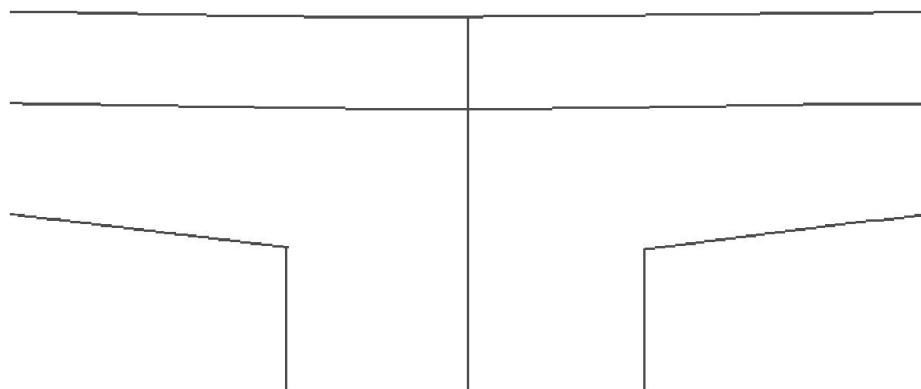



Right ear template.

Fold and glue the template along the lines

Attach Part A and Part B

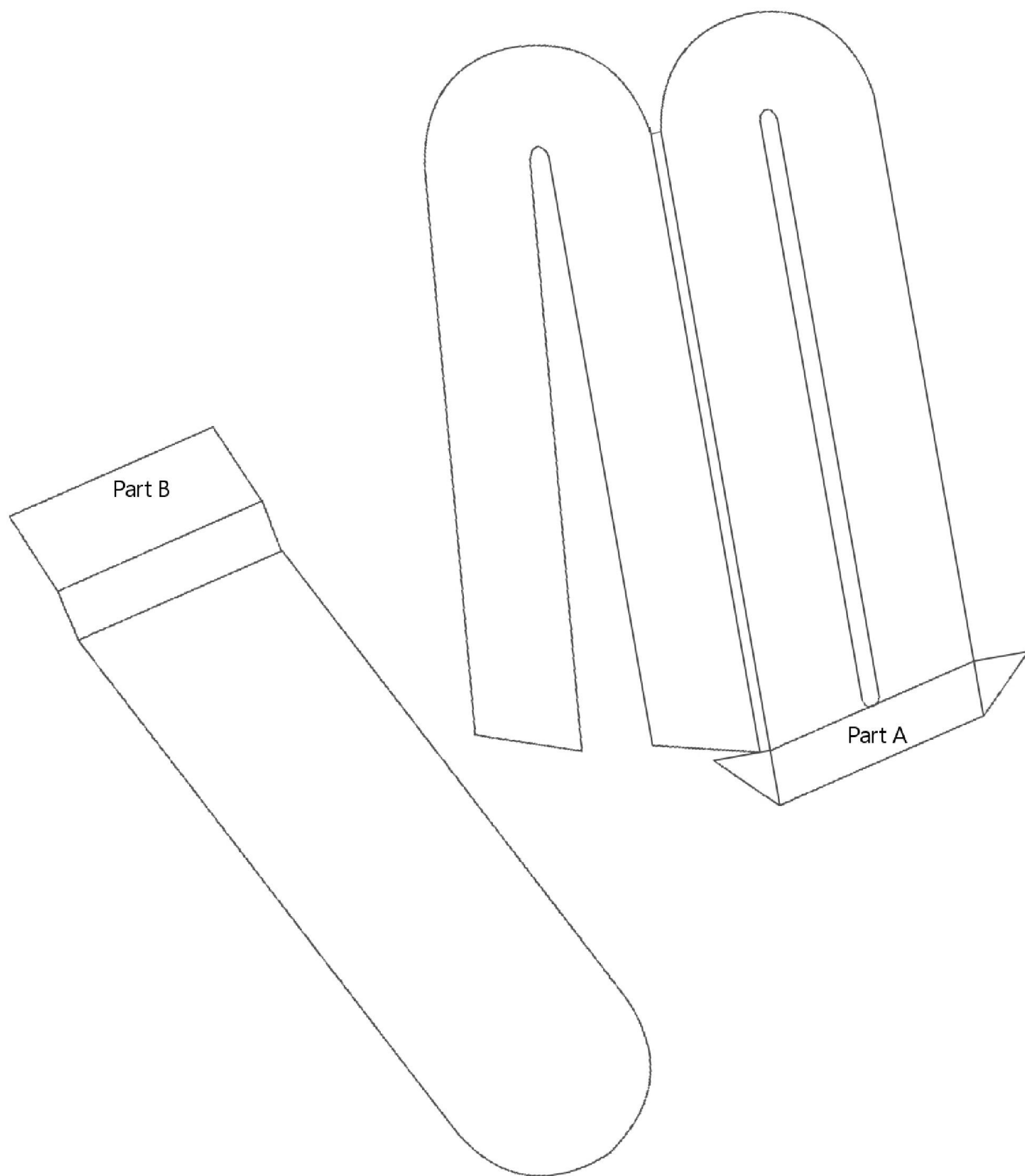

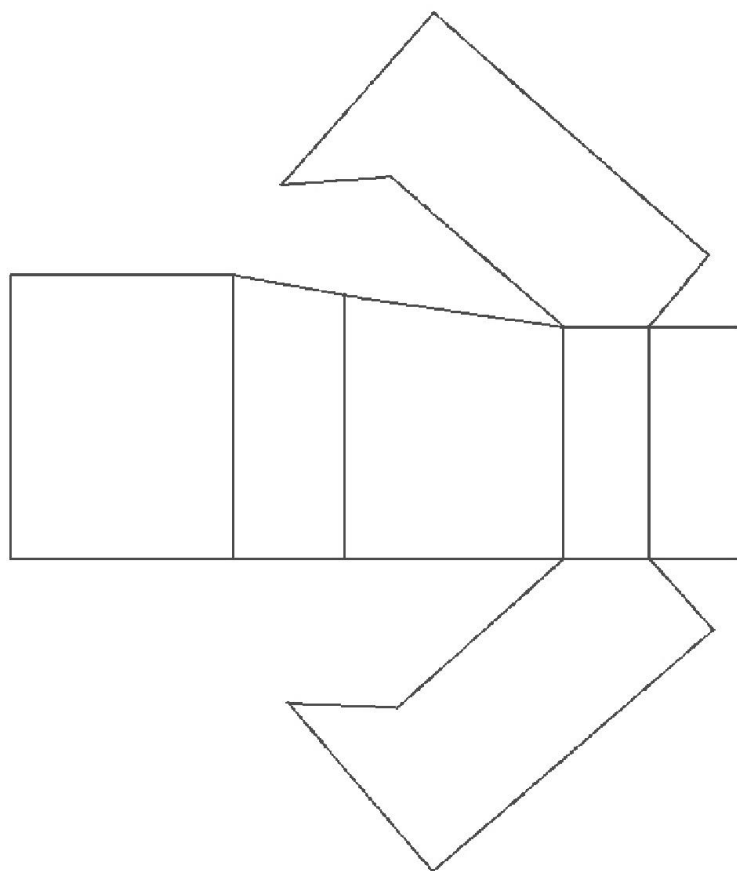

Rangefinder inner template.

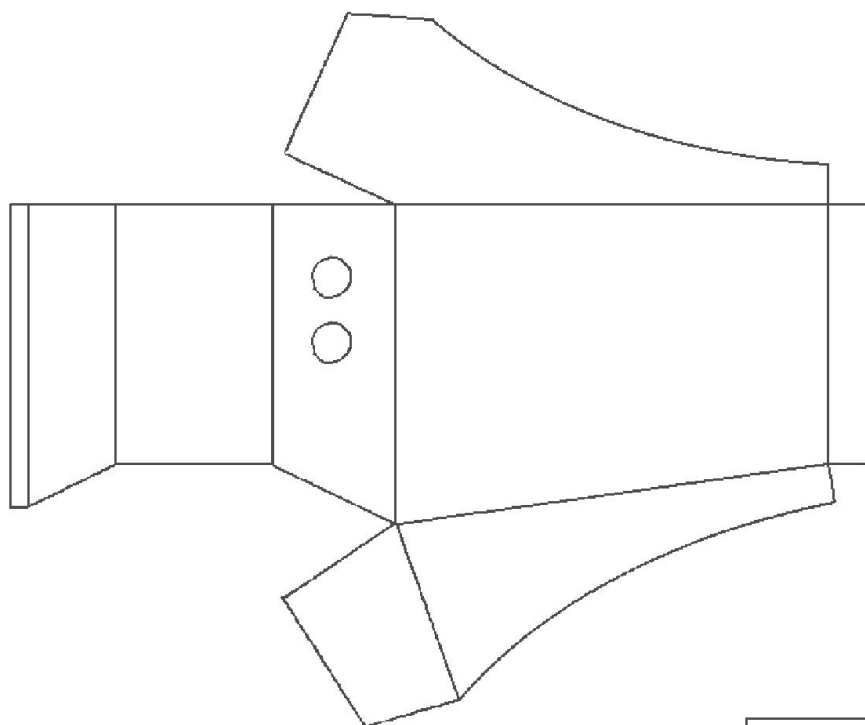

Rangefinder body template.

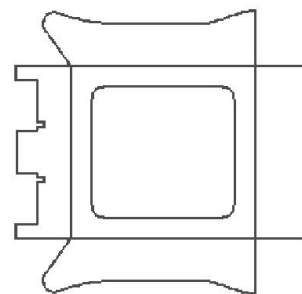

Rangefinder viewfinder template.

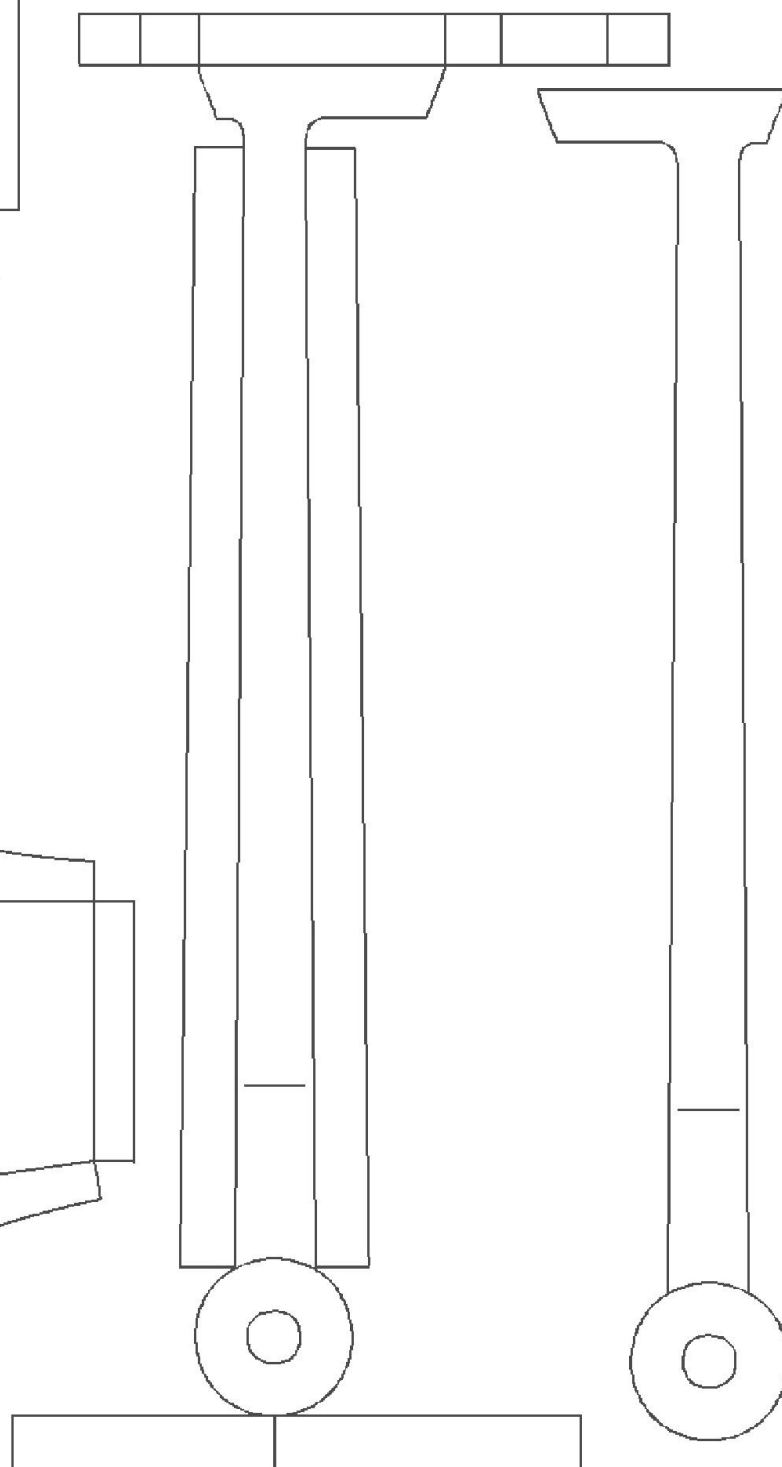

Rangefinder stalk template.



Dome right template.

Glue with the other dome templates
by matching the numbers

1

2

3

4

5

6

7

8



Dome back template.

Glue with the other dome templates by matching the numbers

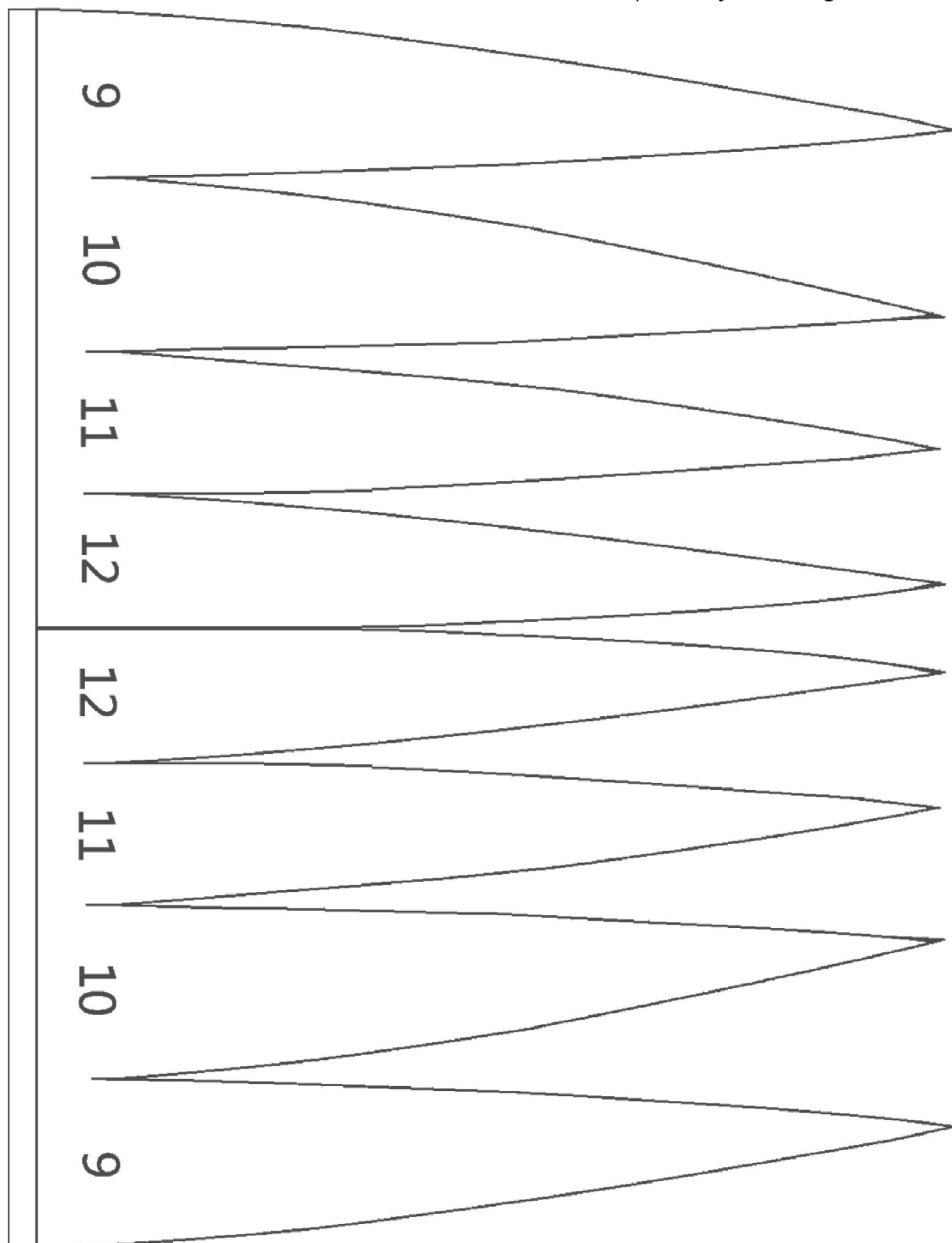



8

7

6

5

4

3

2

1



Dome side template.

Glue this on dome base on the Front-Back line

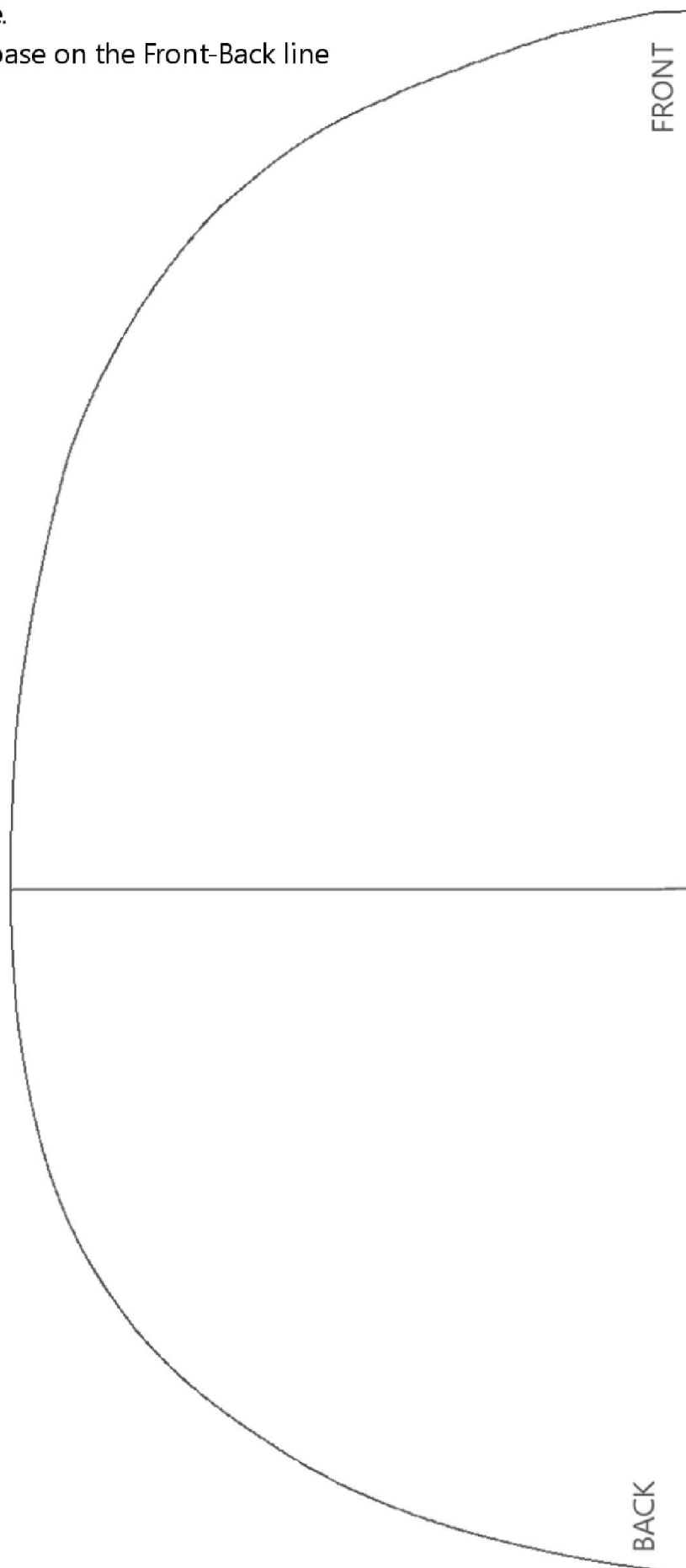



Dome front template.

Glue this on dome base on the Left-Right line

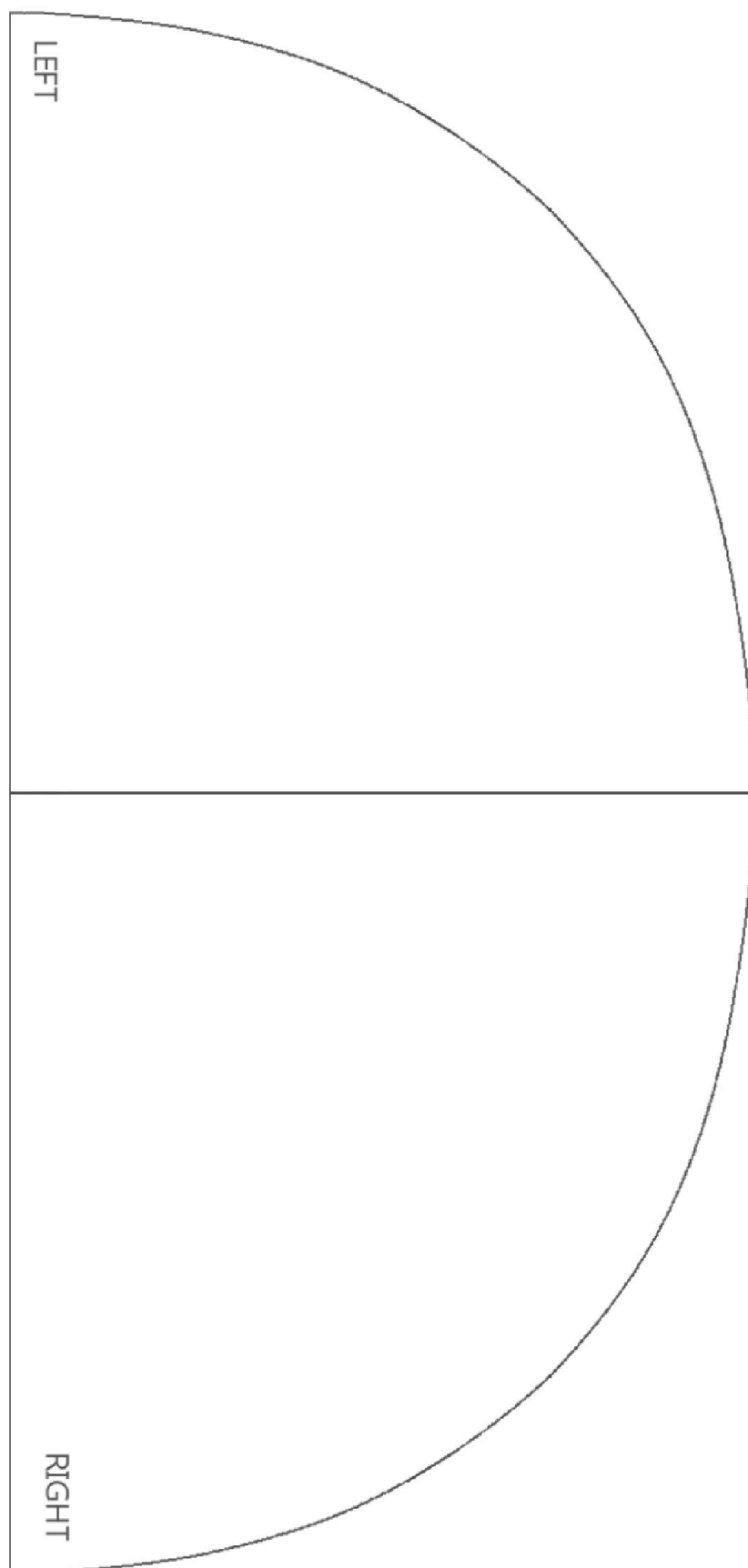



The Dent position

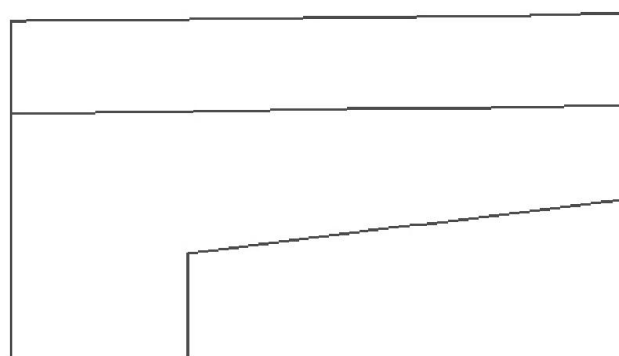
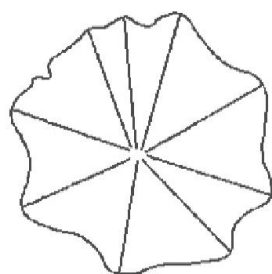

MQ-1 circuit board

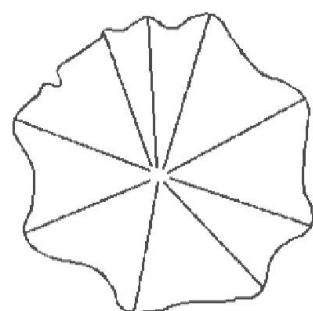
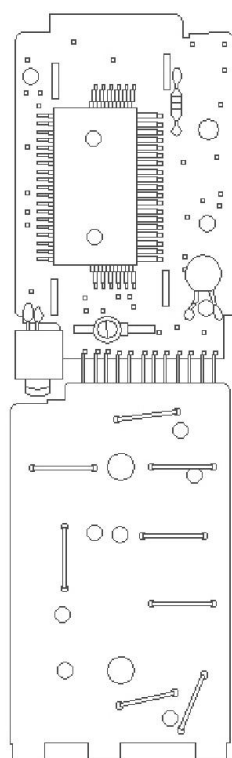

Dent assembly

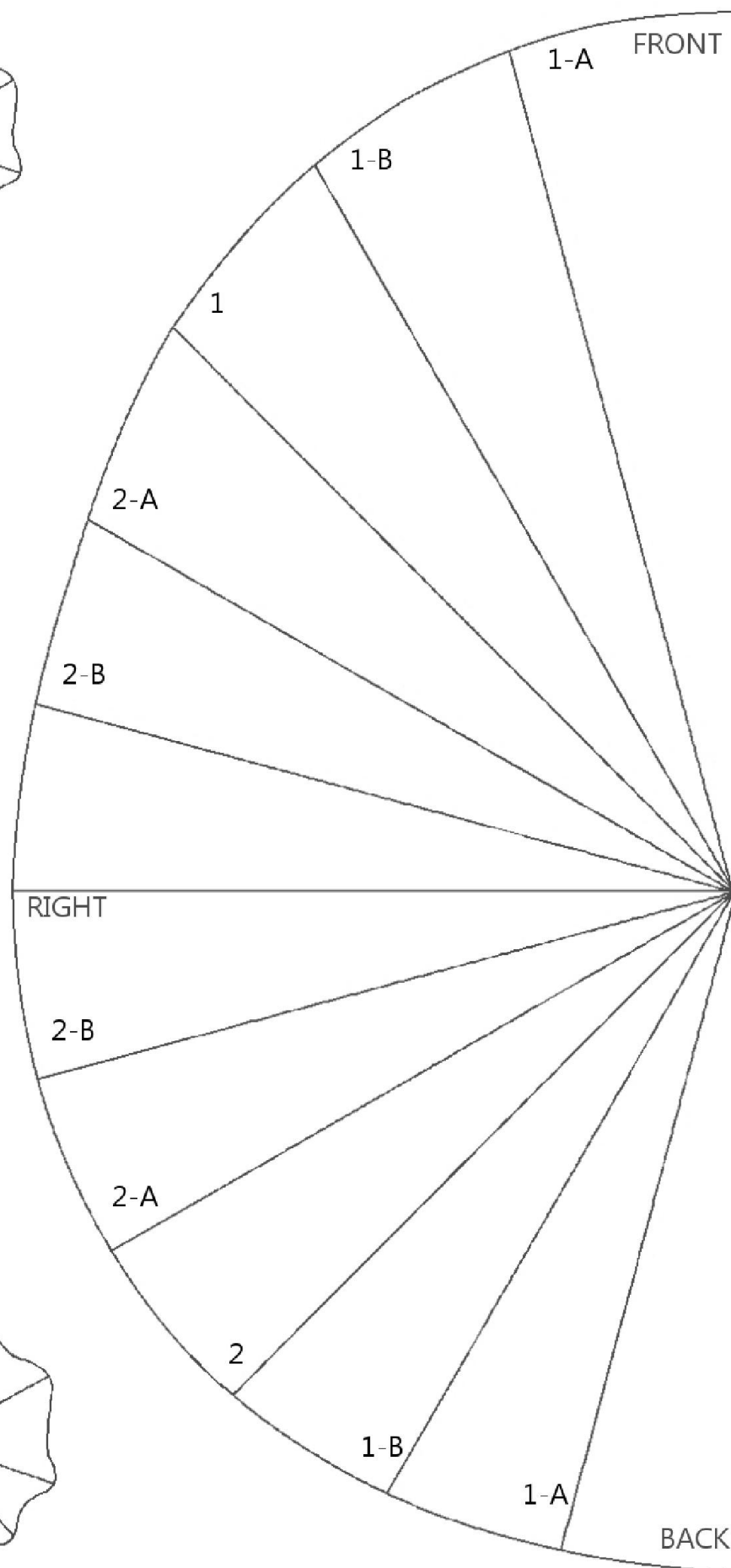



Rear panel template.

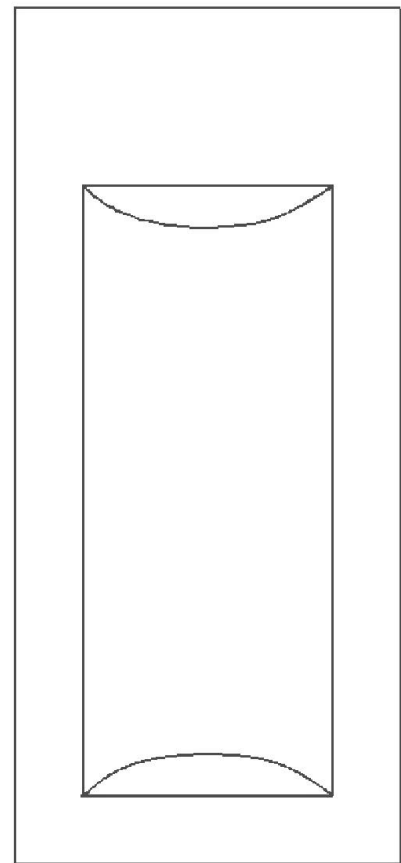

Rear keyhole template.

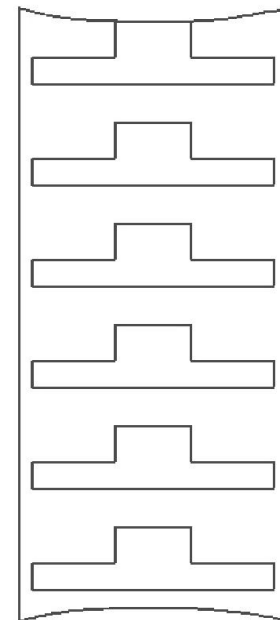

Dome base template.

Match this half with the other half on page 18



Right cheek template.

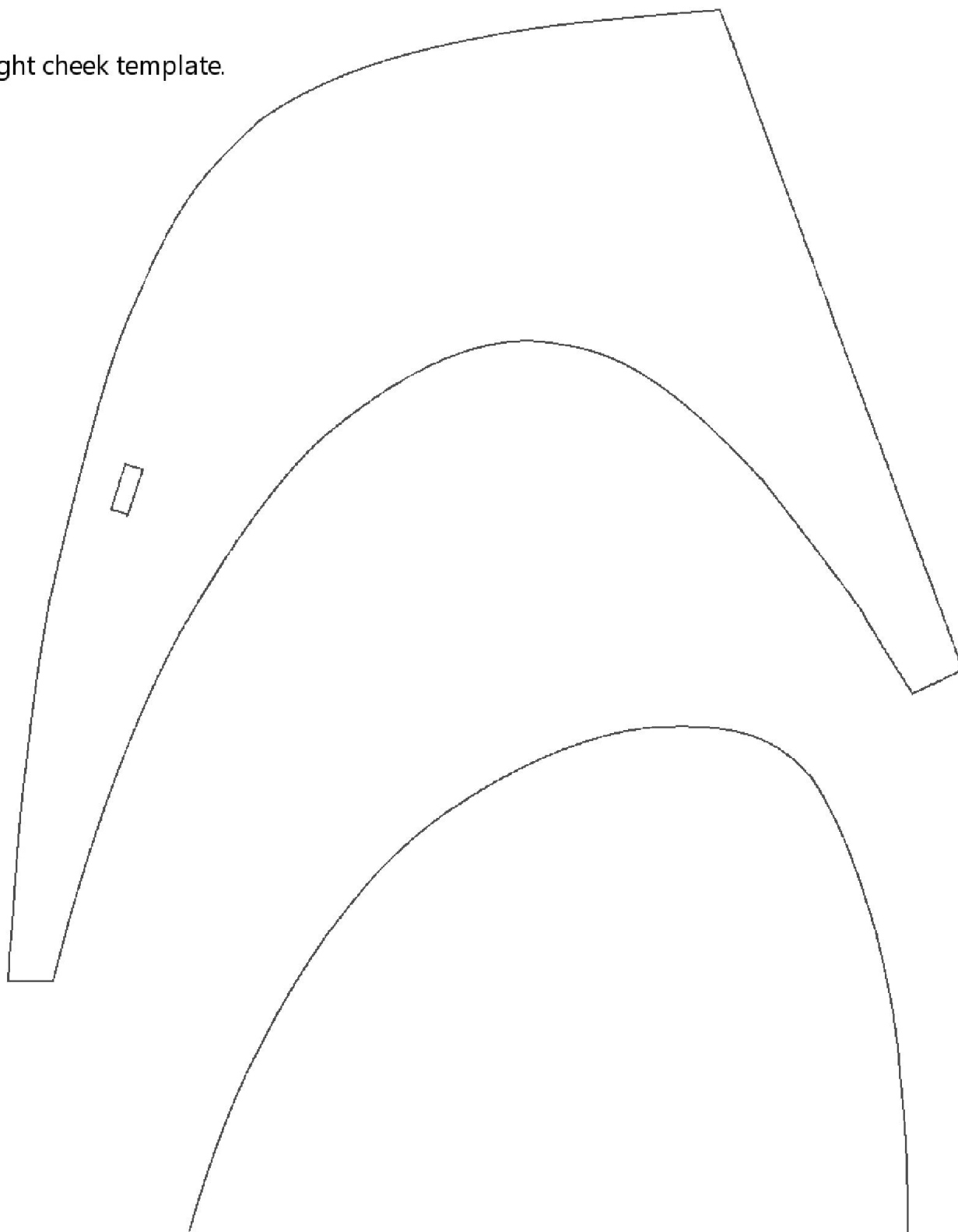



Left cheek template.

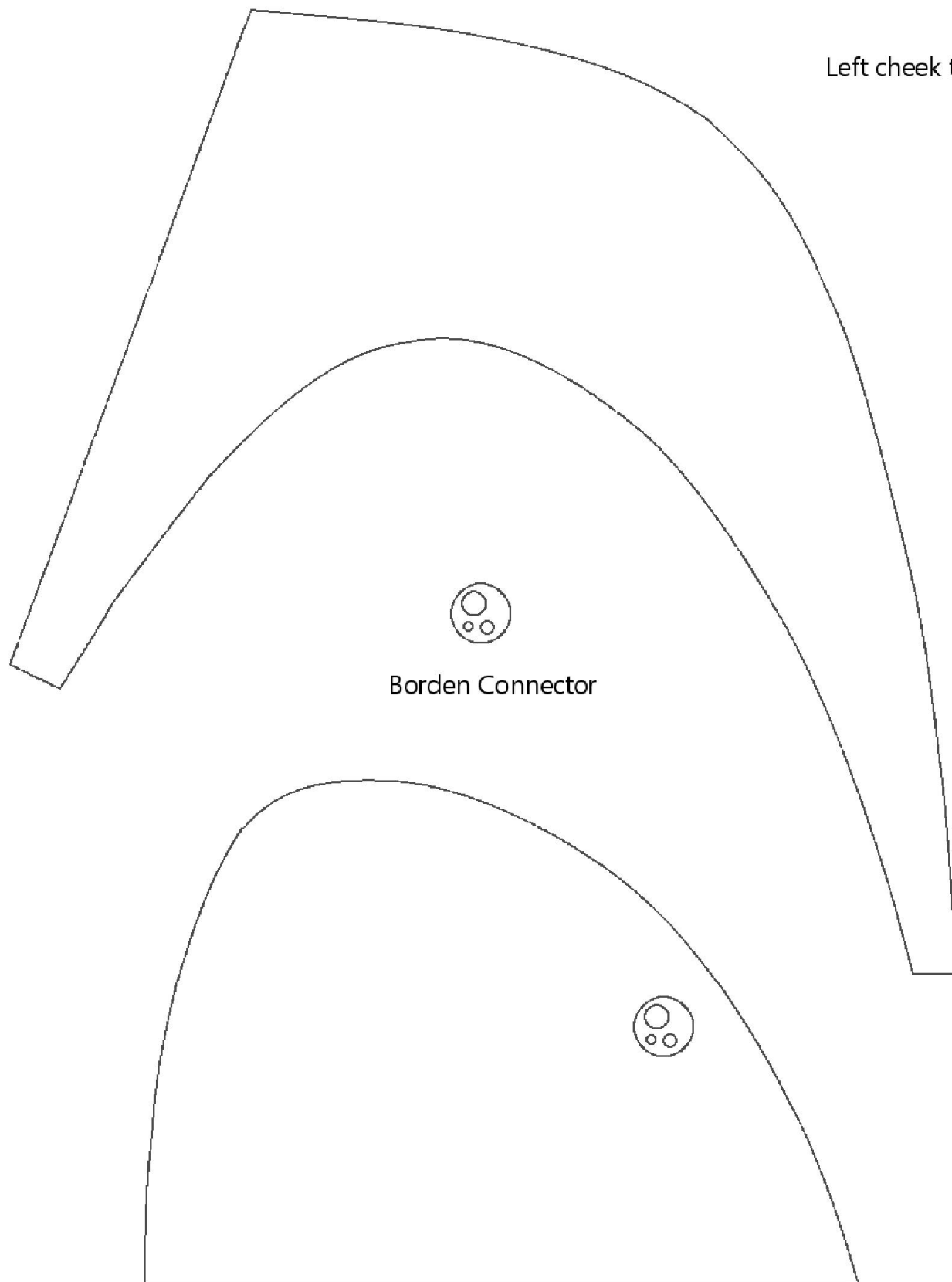



Dome transversal template.

Glue the templates on the dome base on the 1 line

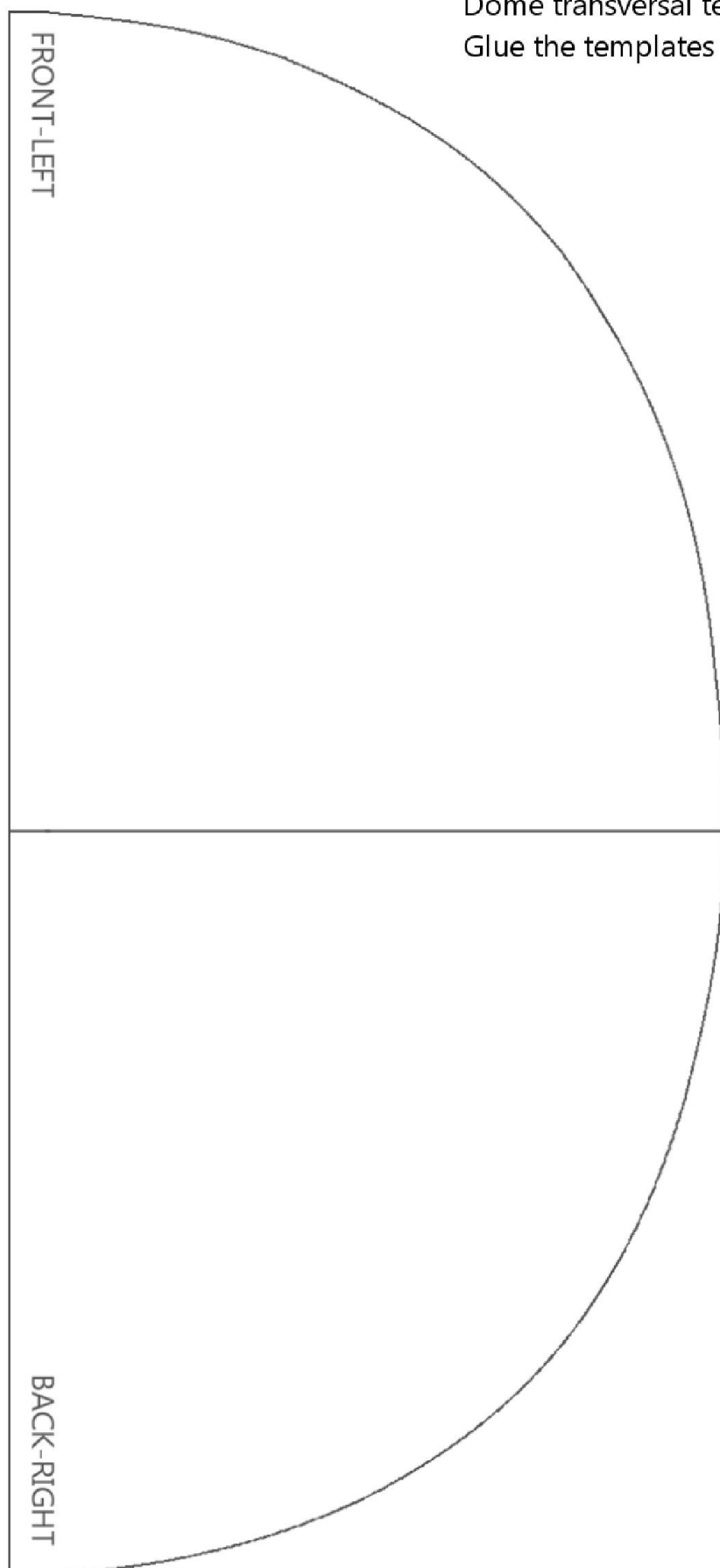



Dome transversal template.

Glue the templates on the dome base on the 2 line

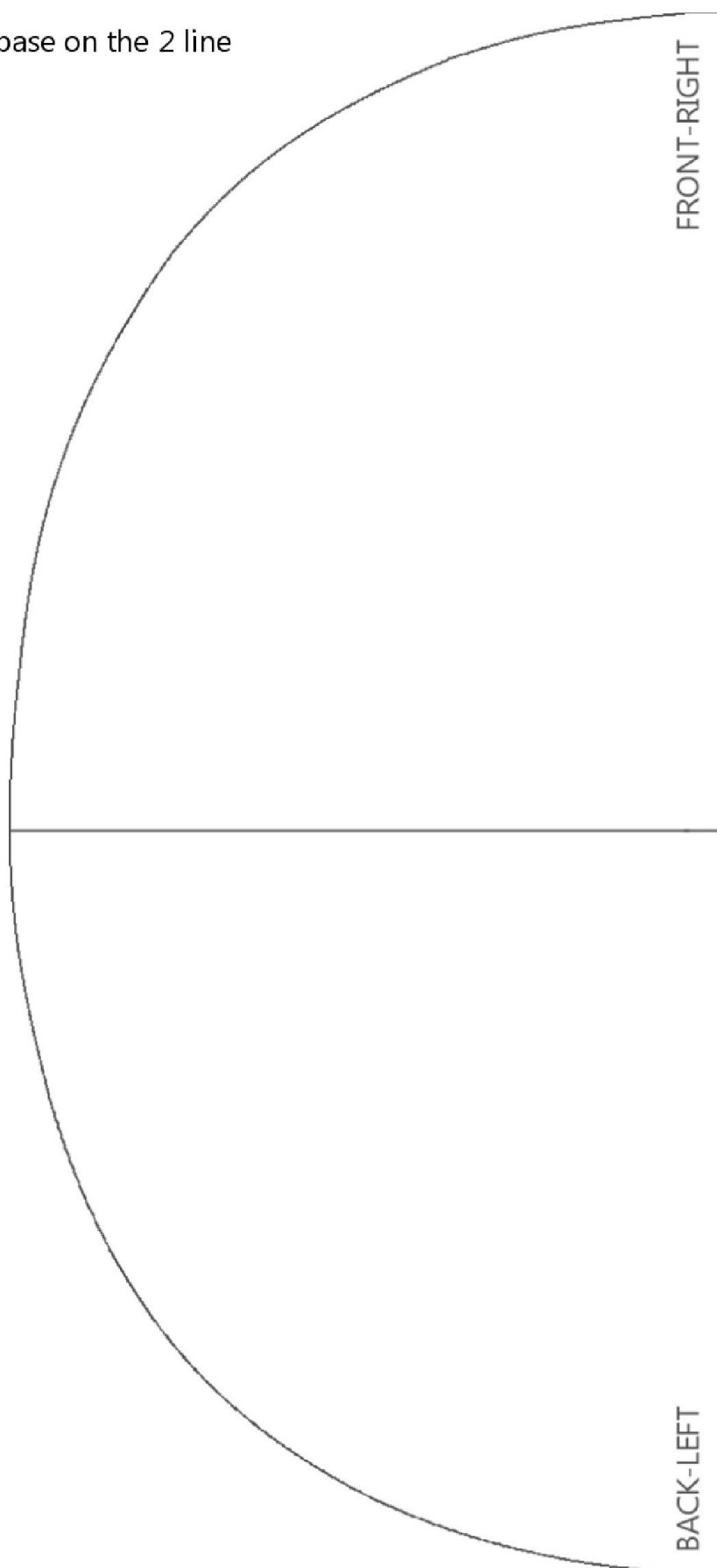



Dome transversal templates.

Glue two Front-Left 1 template on the 1-B lines

FRONT-LEFT 1



Dome transversal templates.

Glue two Front-Left 3 template on the 2-A lines

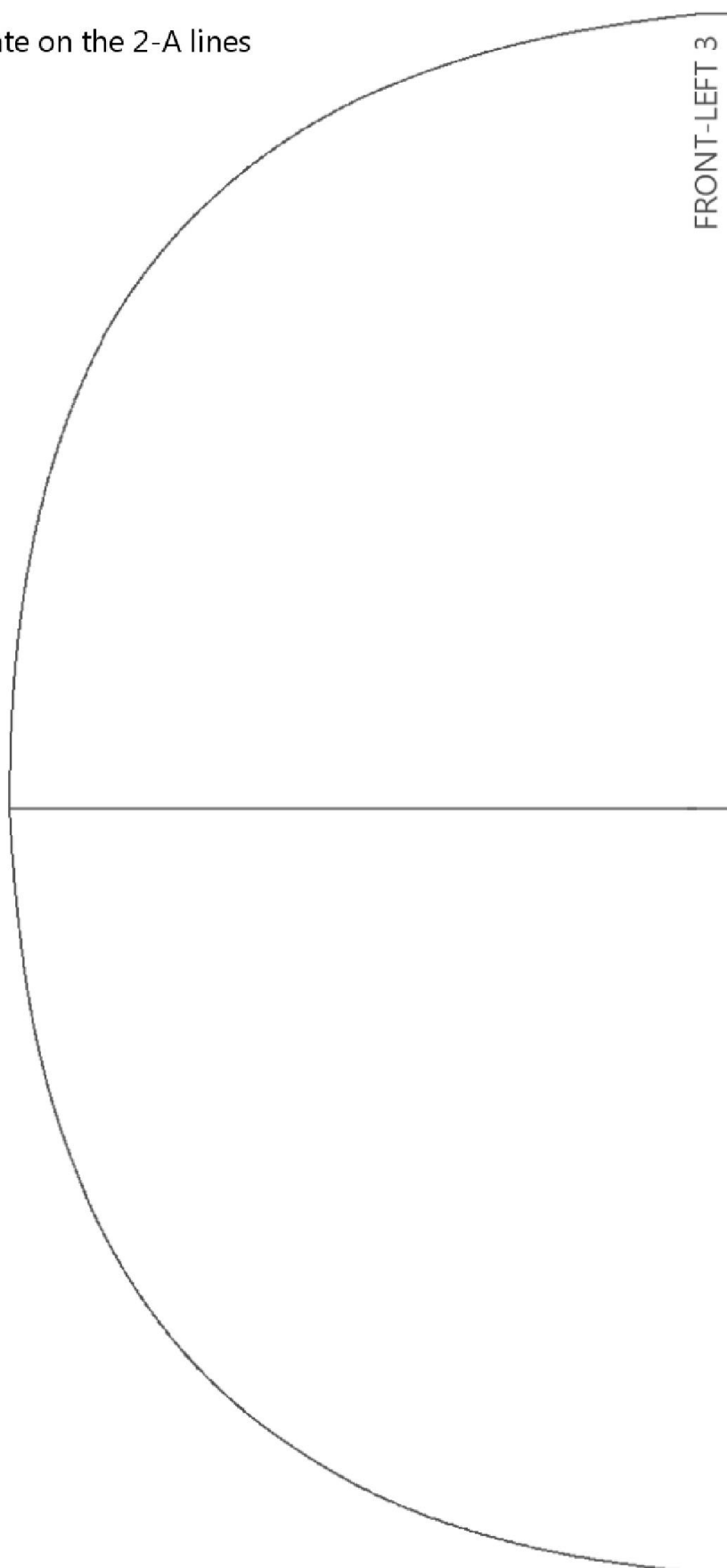



Dome transversal templates.

Glue two Front-Left 4 template on the 2-B lines

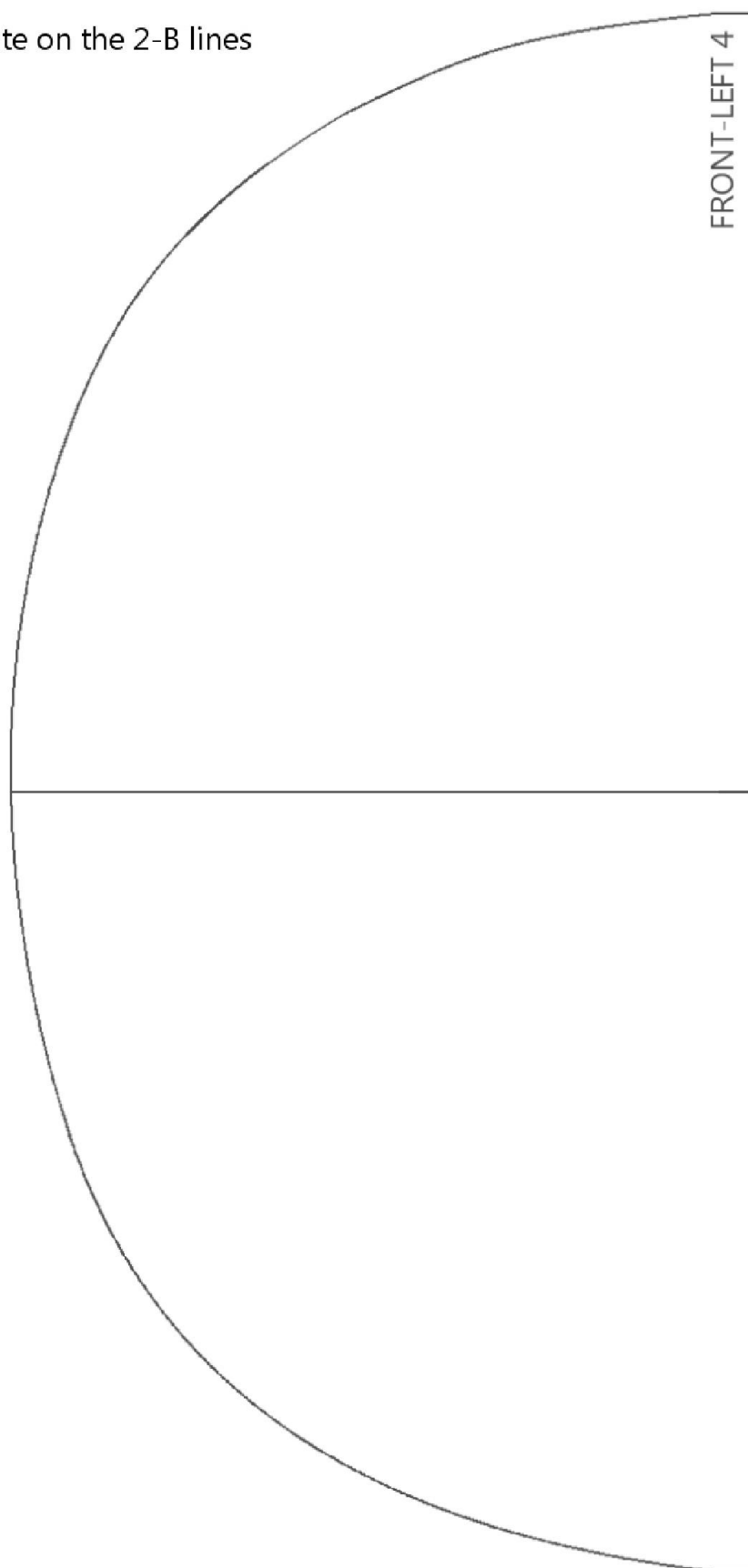



Dome transversal templates.

Glue two Front-Left 2 template on the 1-A lines

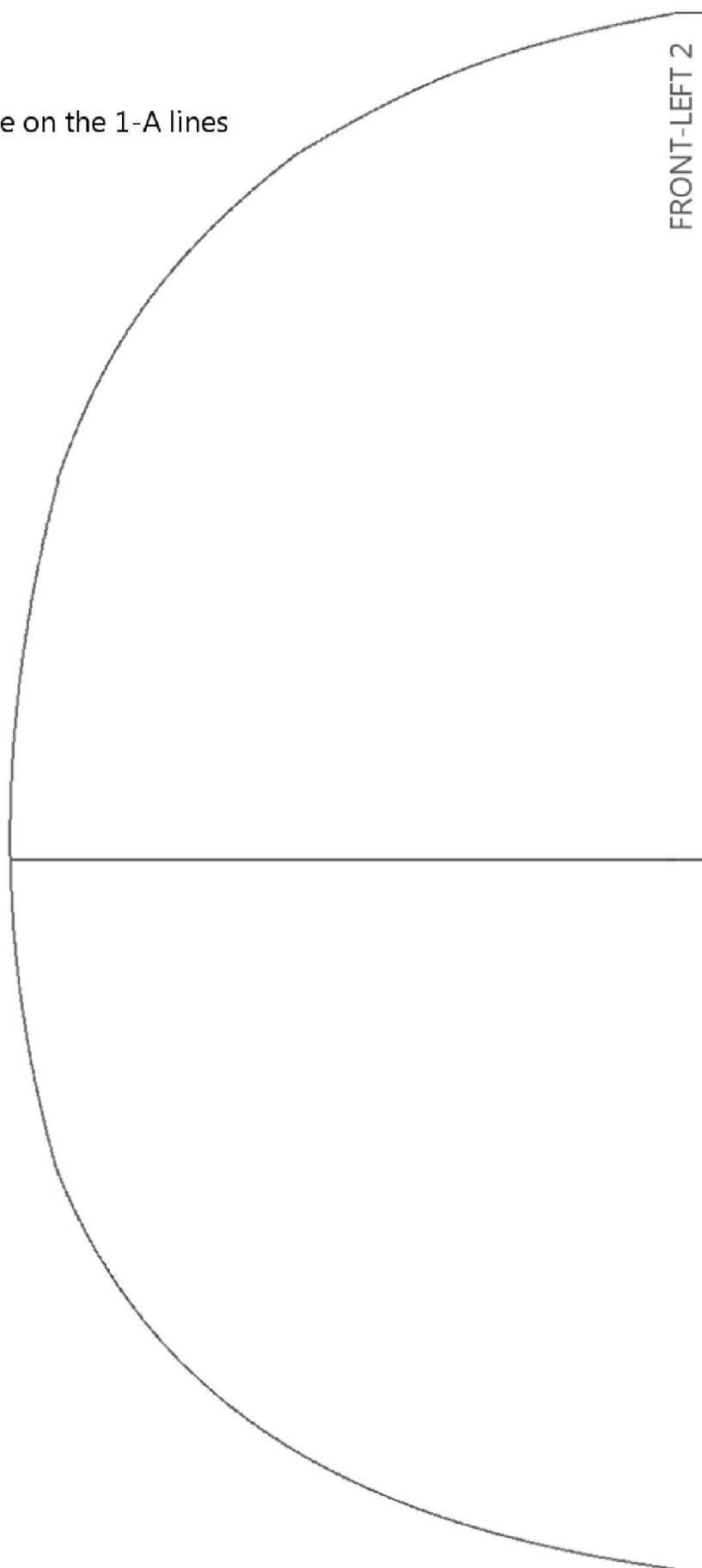

FRONT-LEFT 2



Helmet front template.

Glue this on the helmet base on the Left-Right line

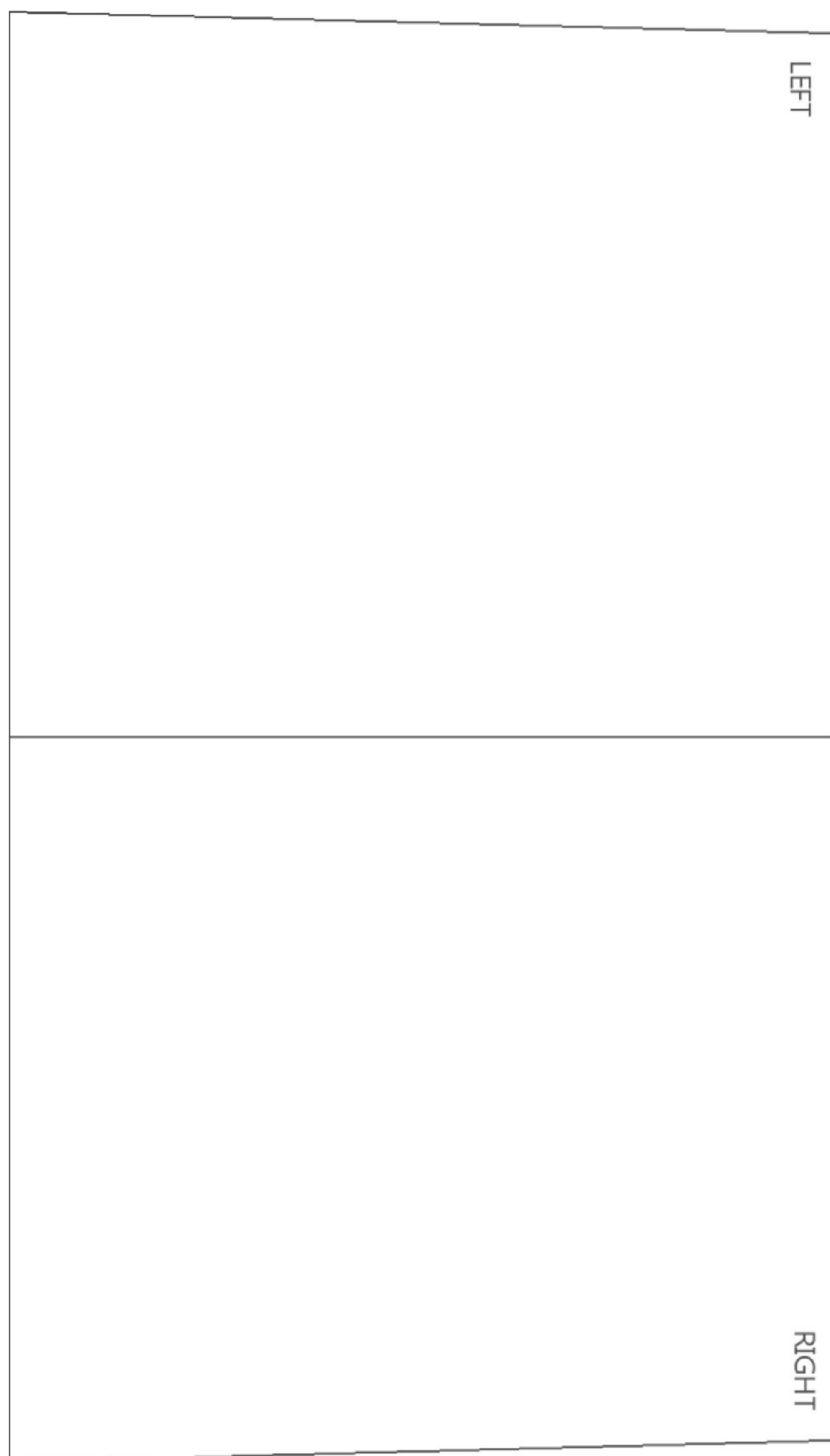



Helmet side template.

Glue this on the helmet base on the Front-Back line

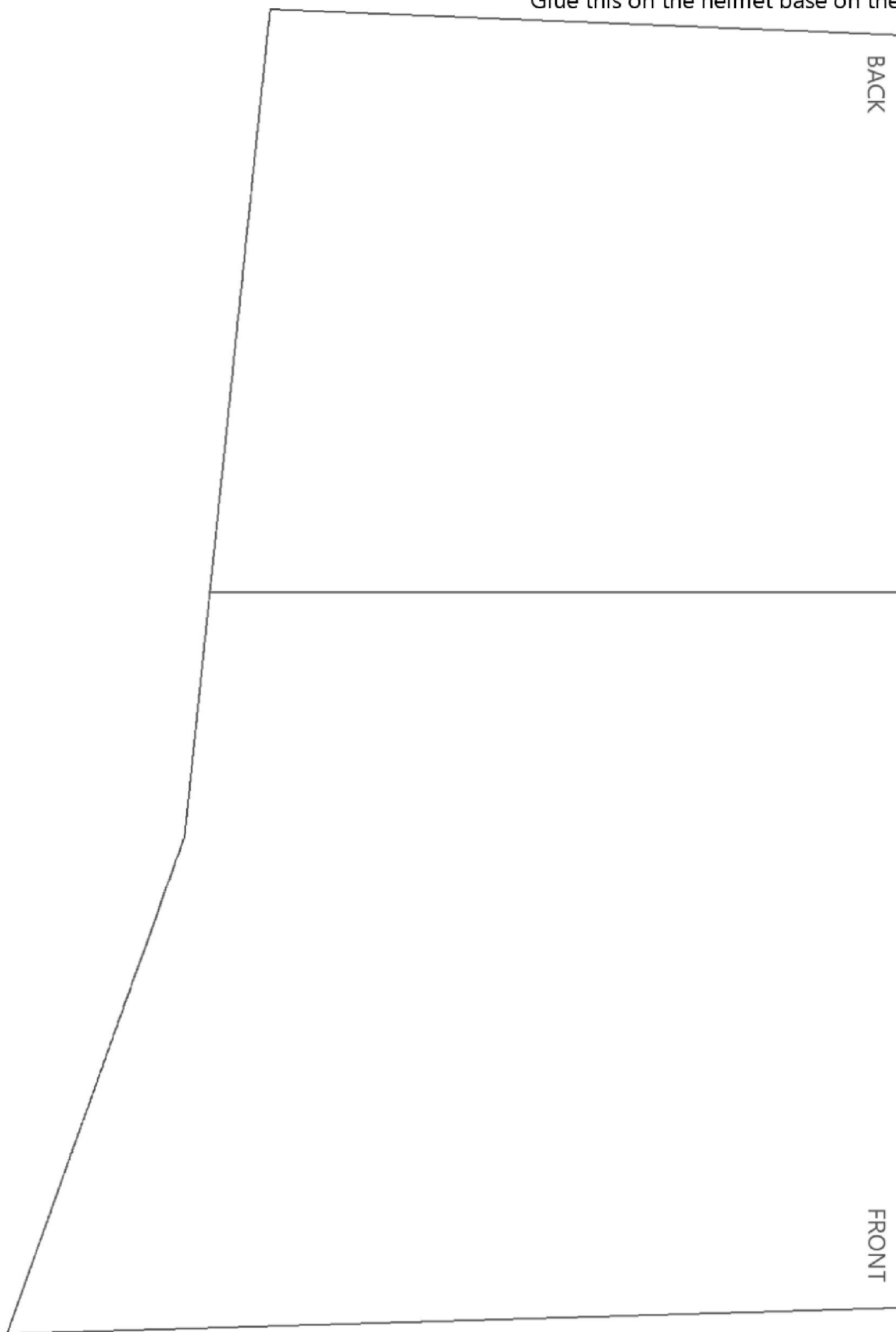



Rafal Works Helmet (RWH) Templates

Copyright © 2003-2011 Rafal Works. All rights reserved.

Helmet transversal template.

Glue this on the helmet base on the transversal line

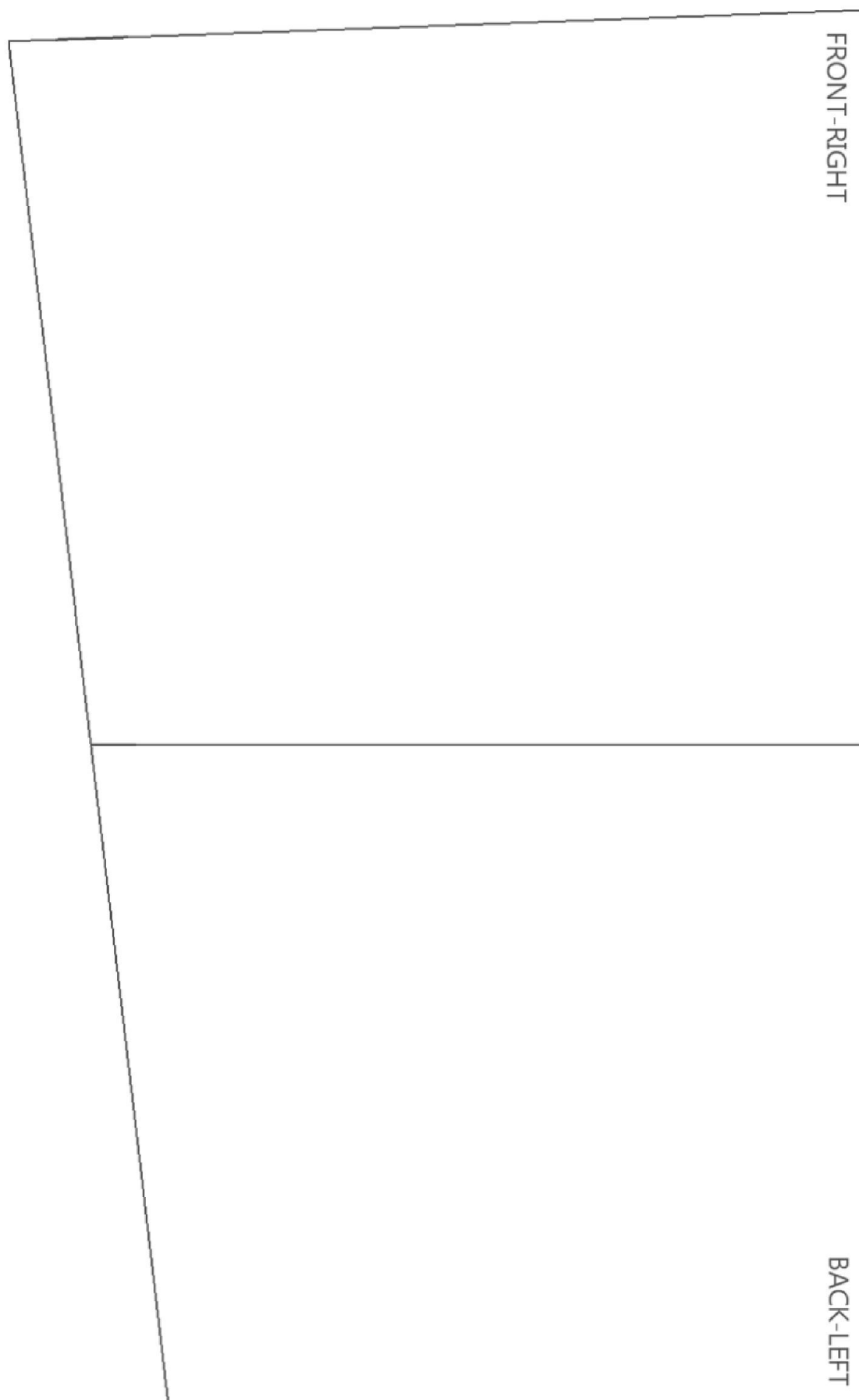



Helmet transversal template.

Glue this on the helmet base on the transversal line





Helmet base template.

Match this half with the other half on page 33

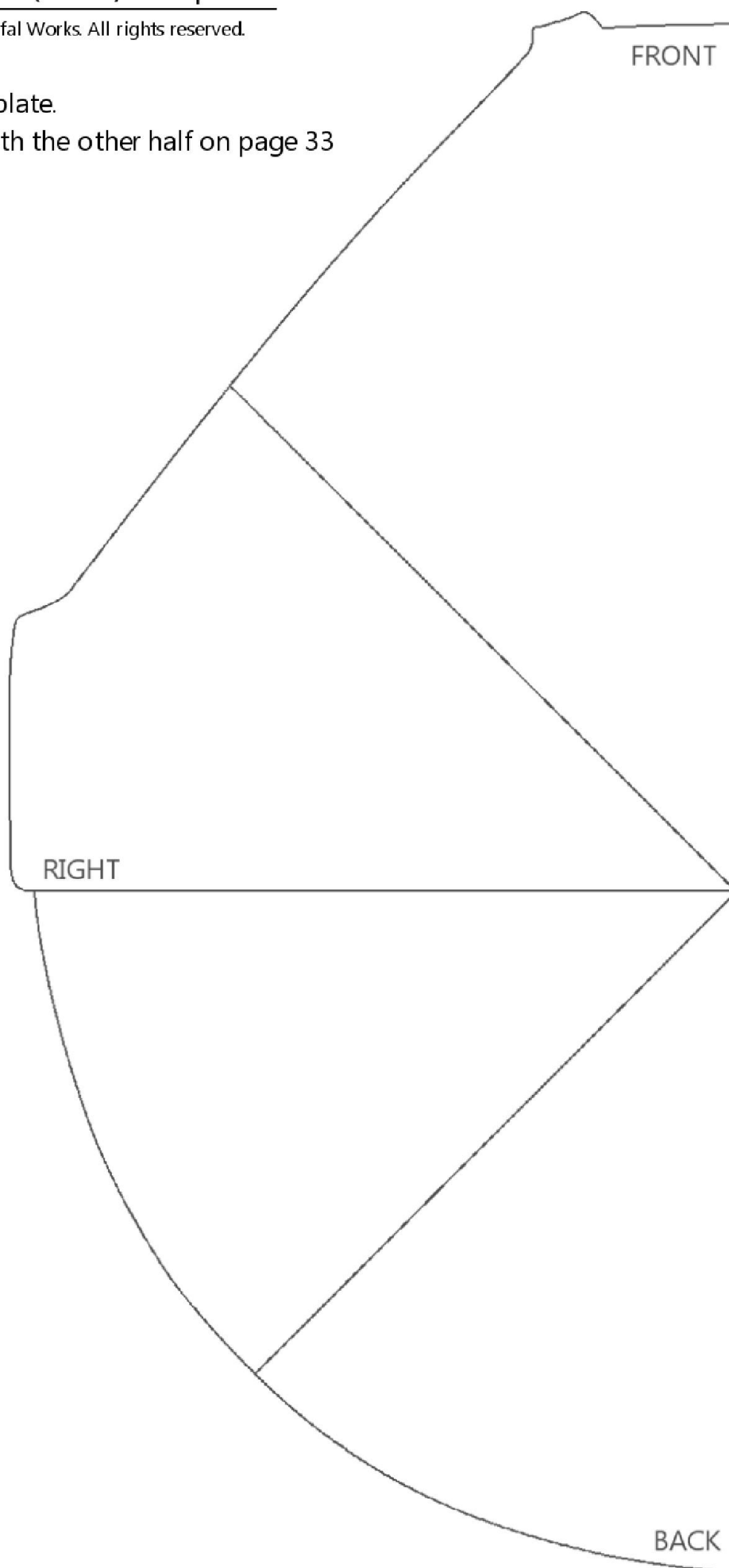



Helmet base template.

Match this half with the other half on page 32

